

GENERAL NOTES:

These drawings are intended solely to act as an aid when designing a wall. This drawing should not be used for final design or construction. Each site-specific wall should be certified and signed by a registered geotechnical engineer in the State or Province that it is being built. The accuracy and use of the details in this document are the sole responsibility of the user.

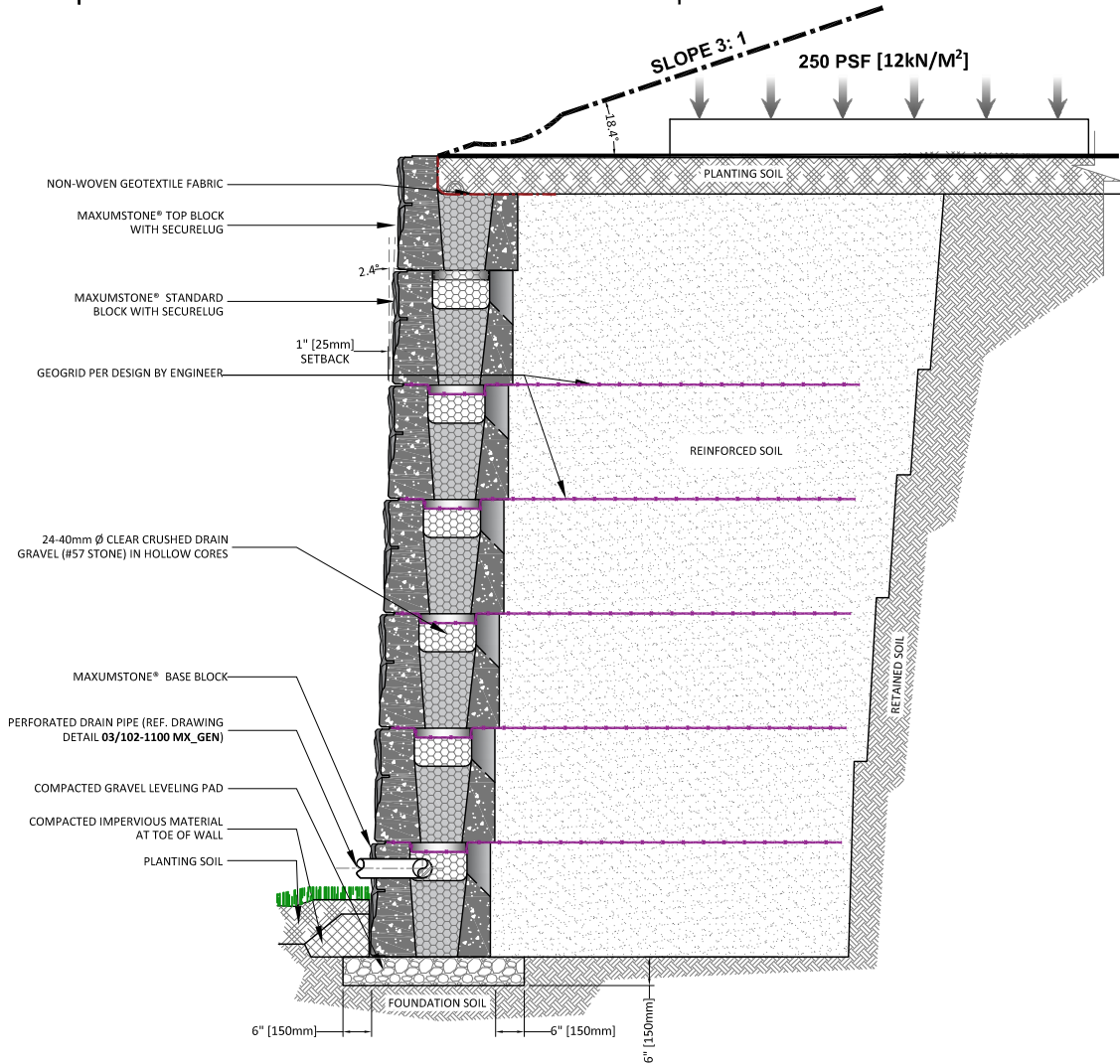

GEOGRID WALL TYPICAL CROSS SECTION

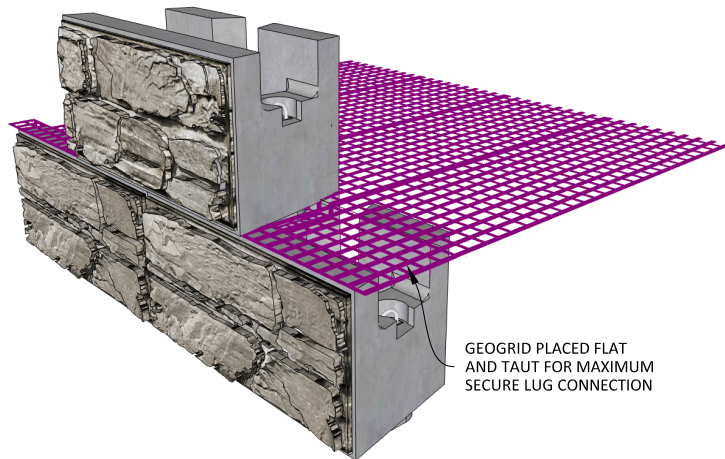

ISOMETRIC VIEW

GENERAL NOTE:
FOLLOW PROPER INSTALLATION GUIDELINE AS PER THE MAXUMSTONE® INSTALLATION MANUAL. ENSURE LOCAL CODES AND GUIDELINES ARE ALWAYS BEING FOLLOWED

DESCRIPTION

SLOPE ANGLE	0°
LIVE LOAD	0 PSF
RETAINED SOIL	26°
FOUNDATION	26°
REINFORCED SOIL	26°
LEVELING PAD	CRUSHED GRAVEL

GENERAL NOTES:

These drawings are intended solely to act as an aid when designing a wall. This drawing should not be used for final design or construction. Each site-specific wall should be certified and signed by a registered geotechnical engineer in the State or Province that it is being built. The accuracy and use of the details in this document are the sole responsibility of the user.

301

1101-MX-GEO

SHEET REFERENCE

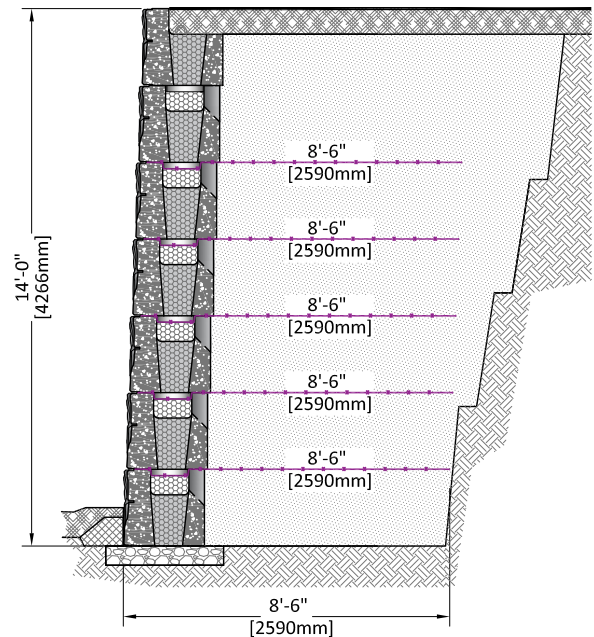
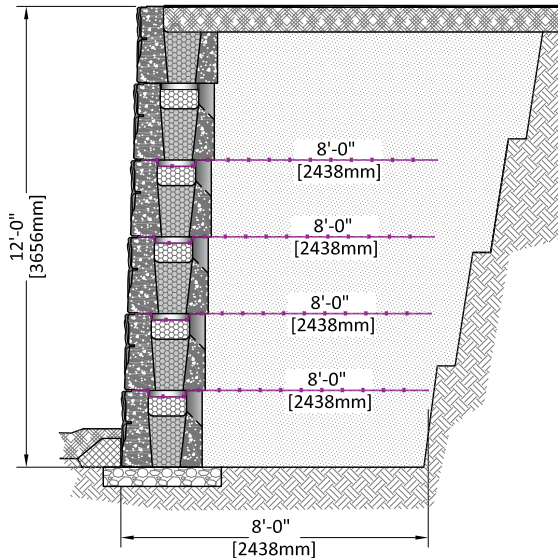
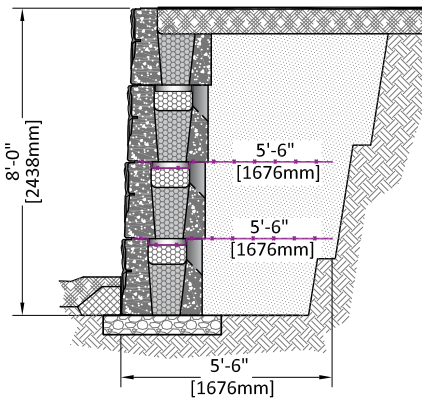
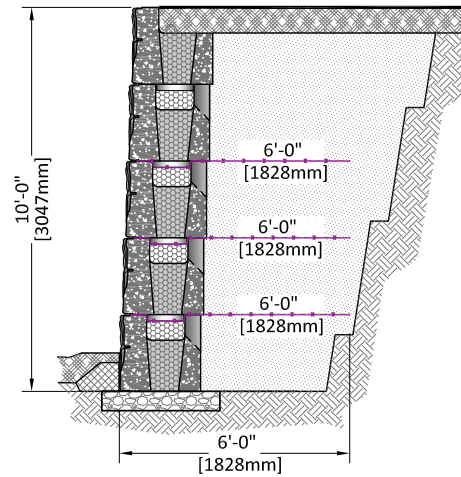
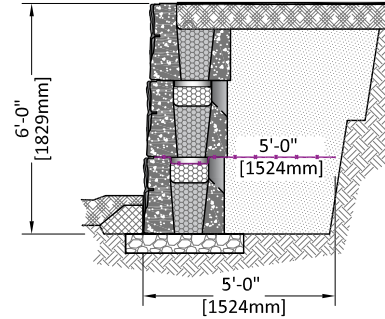

DESCRIPTION

SLOPE ANGLE	0°
LIVE LOAD	0 PSF
RETAINED SOIL	28°
FOUNDATION	28°
REINFORCED SOIL	28°
LEVELING PAD	CRUSHED GRAVEL

GENERAL NOTES:

These drawings are intended solely to act as an aid when designing a wall. This drawing should not be used for final design or construction. Each site-specific wall should be certified and signed by a registered geotechnical engineer in the State or Province that it is being built. The accuracy and use of the details in this document are the sole responsibility of the user.

302

1101-MX-GEO

SHEET REFERENCE

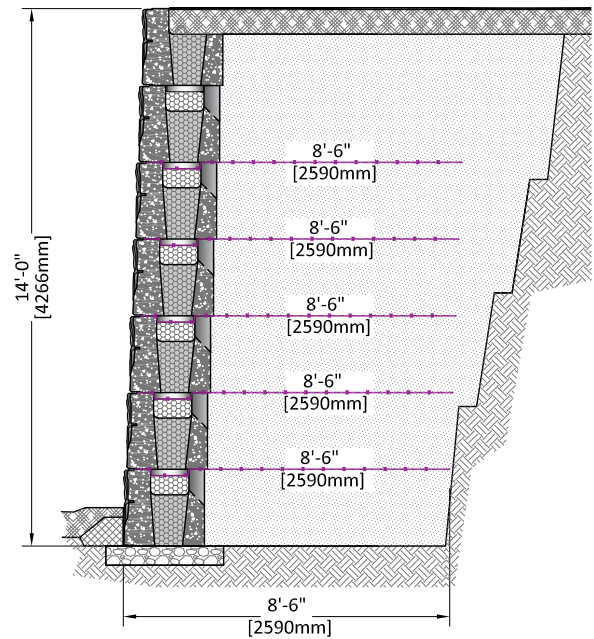
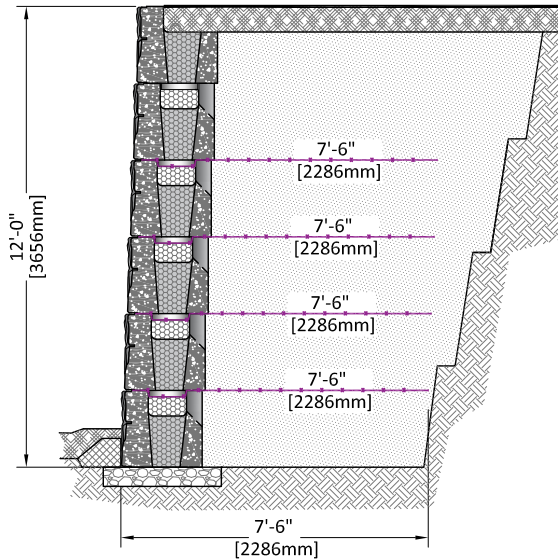
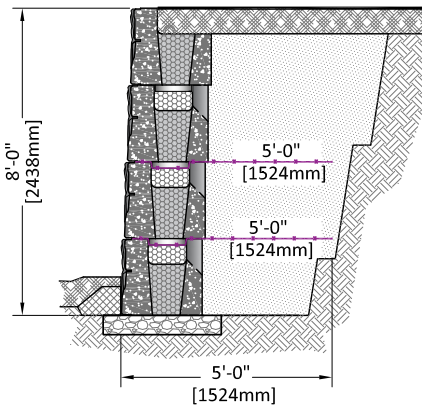
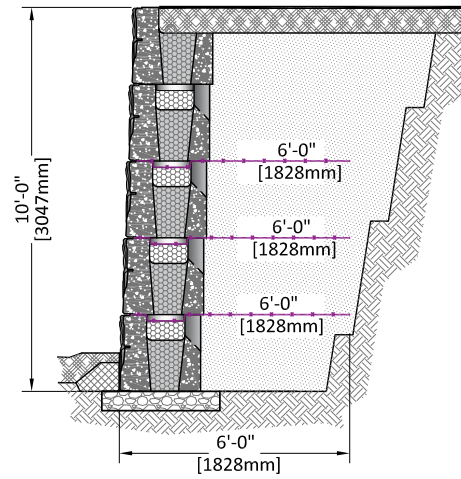
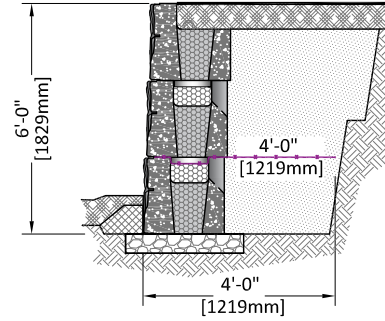

DESCRIPTION

SLOPE ANGLE	0°
LIVE LOAD	0 PSF
RETAINED SOIL	30°
FOUNDATION	30°
REINFORCED SOIL	30°
LEVELING PAD	CRUSHED GRAVEL

GENERAL NOTES:

These drawings are intended solely to act as an aid when designing a wall. This drawing should not be used for final design or construction. Each site-specific wall should be certified and signed by a registered geotechnical engineer in the State or Province that it is being built. The accuracy and use of the details in this document are the sole responsibility of the user.

303

1101-MX-GEO

SHEET REFERENCE

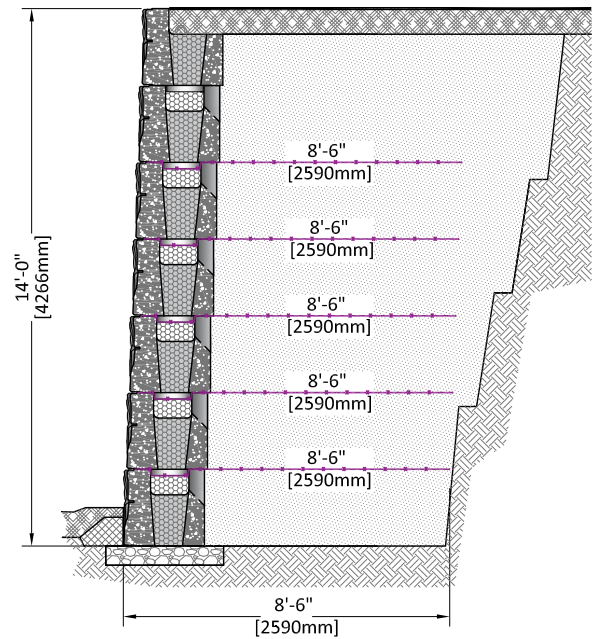
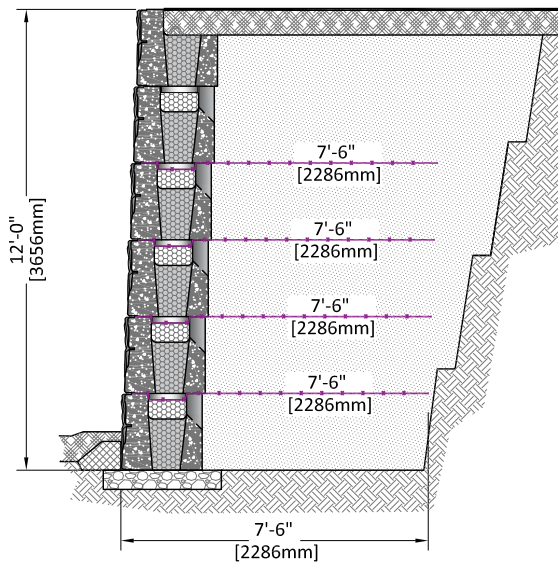
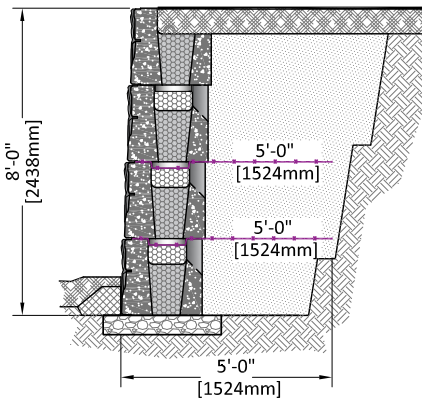
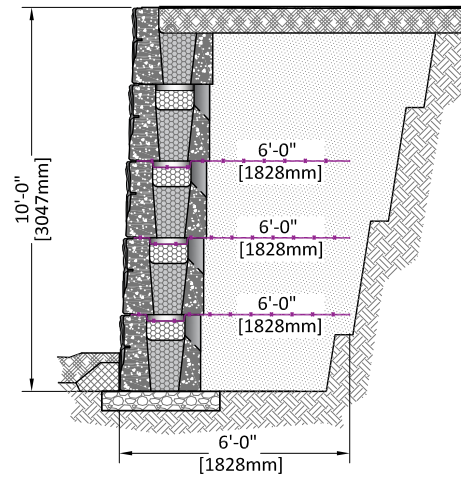
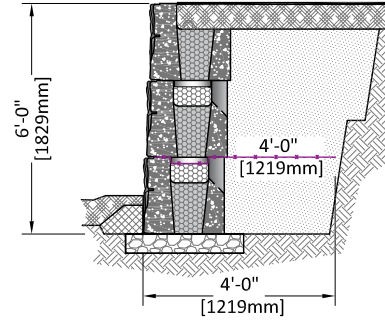

DESCRIPTION

SLOPE ANGLE	0°
LIVE LOAD	250 PSF
RETAINED SOIL	26°
FOUNDATION	26°
REINFORCED SOIL	26°
LEVELING PAD	CRUSHED GRAVEL

GENERAL NOTES:

These drawings are intended solely to act as an aid when designing a wall. This drawing should not be used for final design or construction. Each site-specific wall should be certified and signed by a registered geotechnical engineer in the State or Province that it is being built. The accuracy and use of the details in this document are the sole responsibility of the user.

304

1101-MX-GEO

SHEET REFERENCE

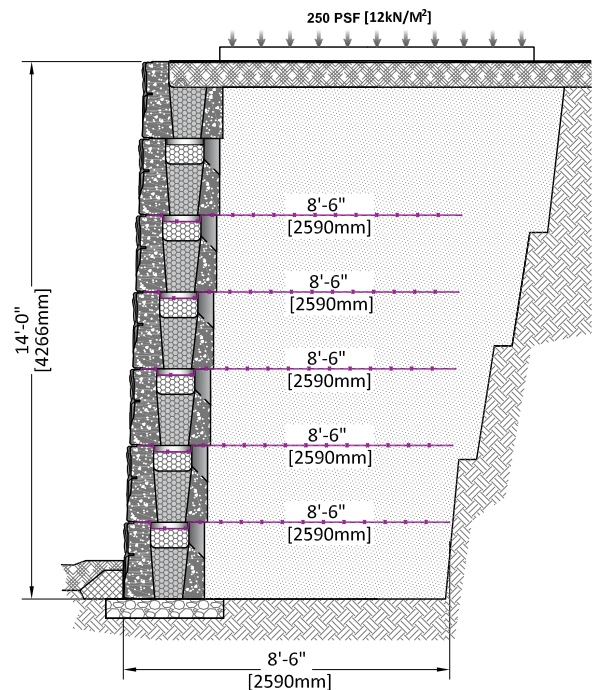
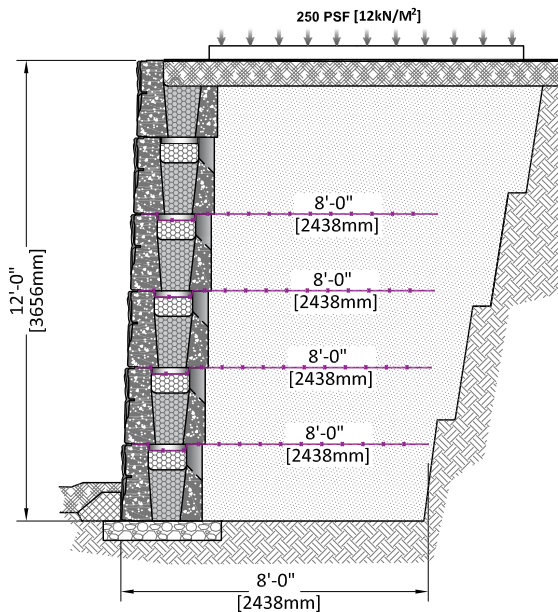
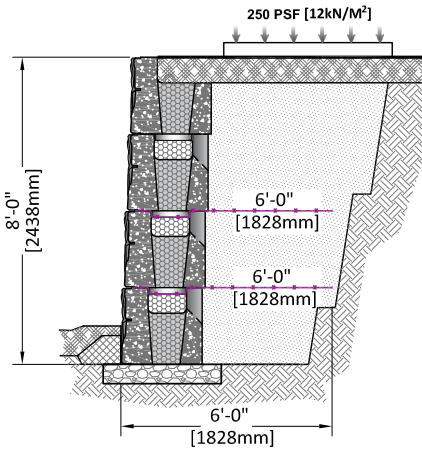
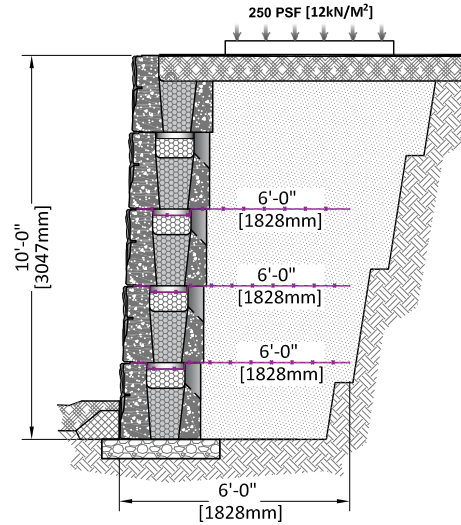
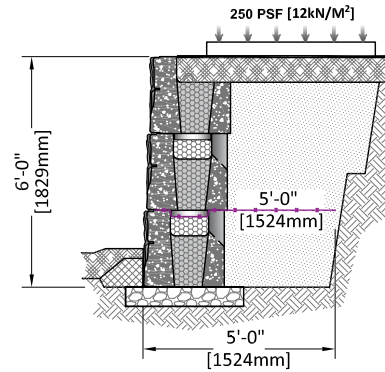

DESCRIPTION

SLOPE ANGLE	0°
LIVE LOAD	250 PSF
RETAINED SOIL	28°
FOUNDATION	28°
REINFORCED SOIL	28°
LEVELING PAD	CRUSHED GRAVEL

GENERAL NOTES:

These drawings are intended solely to act as an aid when designing a wall. This drawing should not be used for final design or construction. Each site-specific wall should be certified and signed by a registered geotechnical engineer in the State or Province that it is being built. The accuracy and use of the details in this document are the sole responsibility of the user.

305

1101-MX-GEO

SHEET REFERENCE

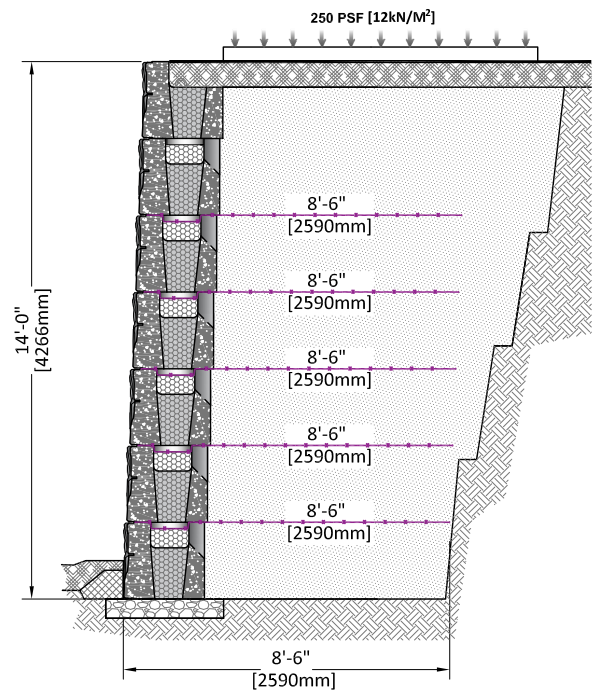
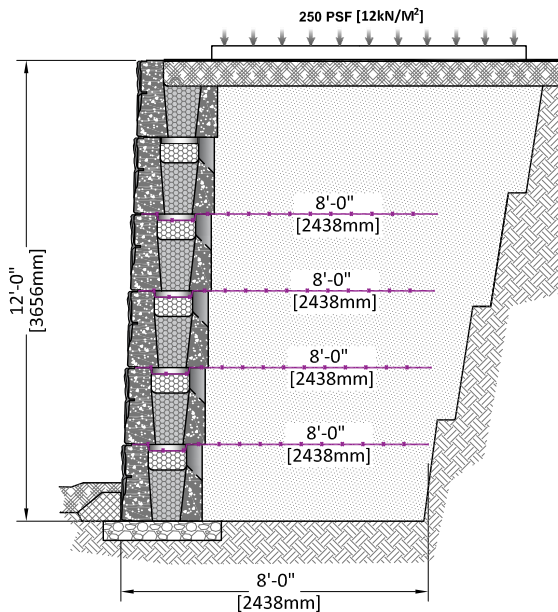
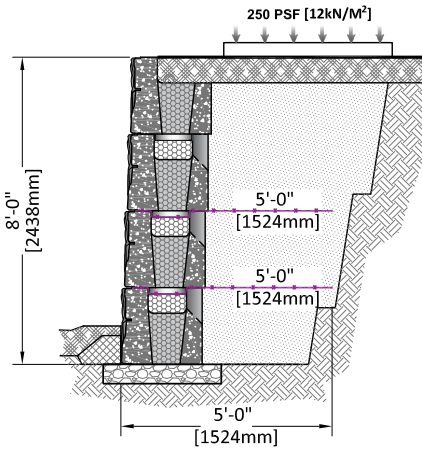
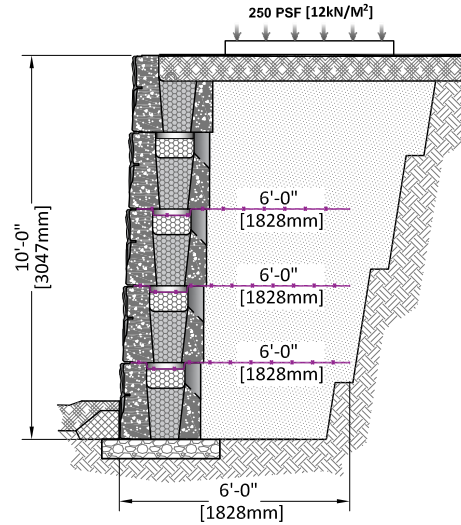
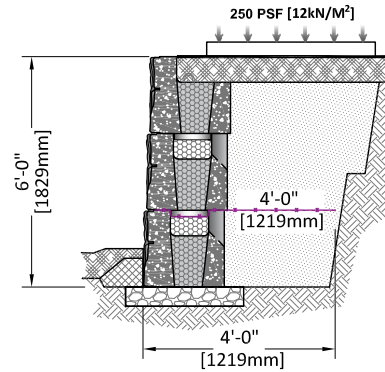

DESCRIPTION

SLOPE ANGLE	0°
LIVE LOAD	250 PSF
RETAINED SOIL	30°
FOUNDATION	30°
REINFORCED SOIL	30°
LEVELING PAD	CRUSHED GRAVEL

GENERAL NOTES:

These drawings are intended solely to act as an aid when designing a wall. This drawing should not be used for final design or construction. Each site-specific wall should be certified and signed by a registered geotechnical engineer in the State or Province that it is being built. The accuracy and use of the details in this document are the sole responsibility of the user.

306

1101-MX-GEO

SHEET REFERENCE

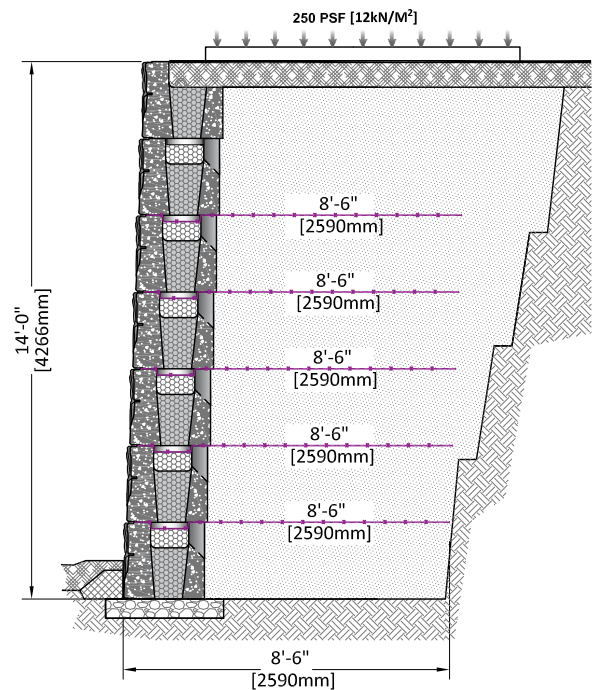
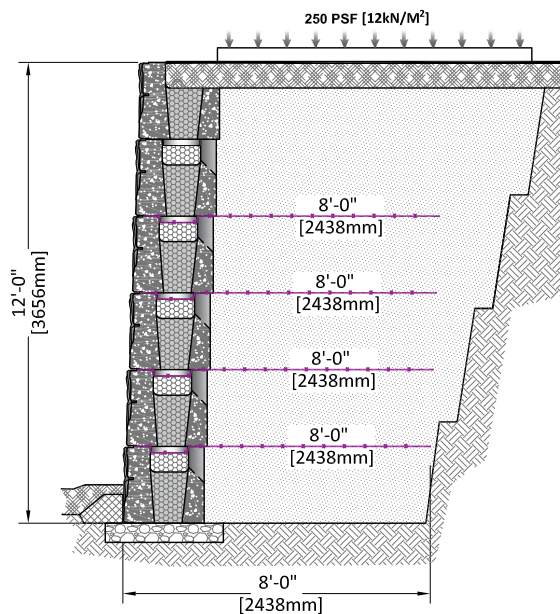
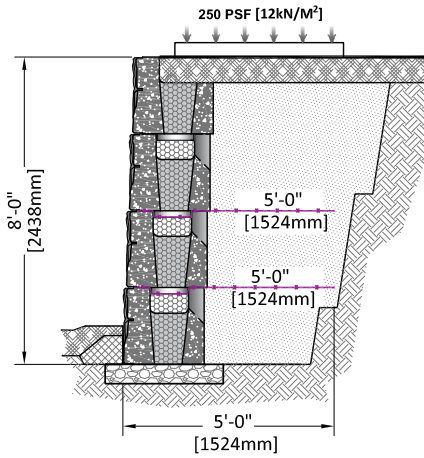
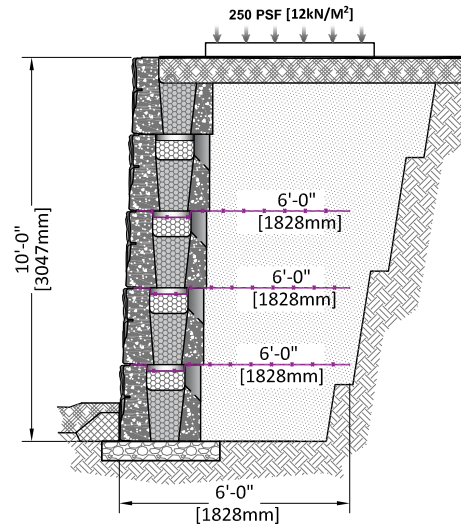
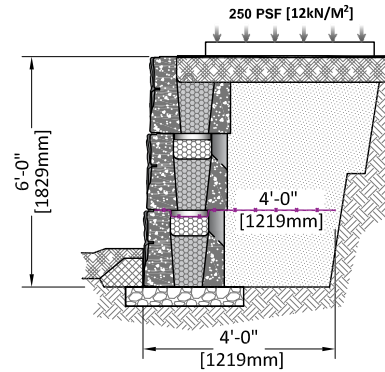

DESCRIPTION

SLOPE ANGLE	18.4° (3H:1V)
LIVE LOAD	0 PSF
RETAINED SOIL	28°
FOUNDATION	28°
REINFORCED SOIL	34°
LEVELING PAD	CRUSHED GRAVEL

GENERAL NOTES:

These drawings are intended solely to act as an aid when designing a wall. This drawing should not be used for final design or construction. Each site-specific wall should be certified and signed by a registered geotechnical engineer in the State or Province that it is being built. The accuracy and use of the details in this document are the sole responsibility of the user.

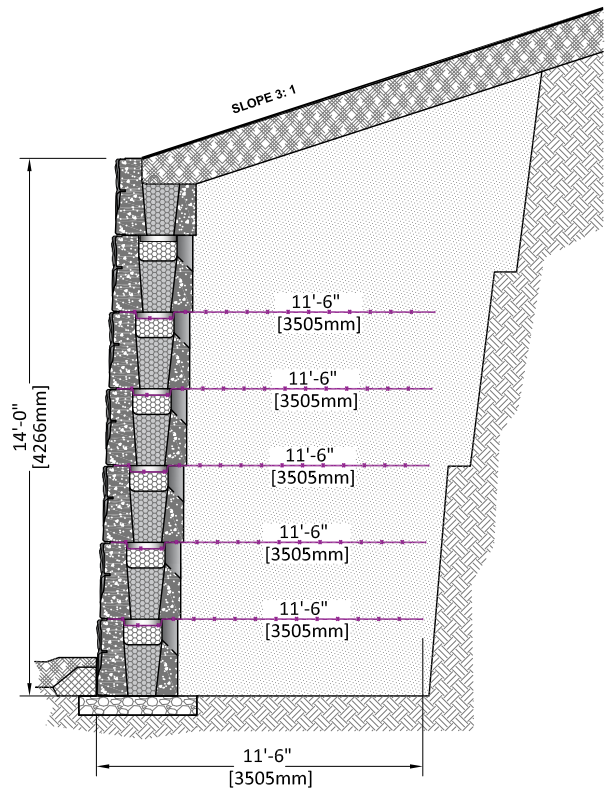
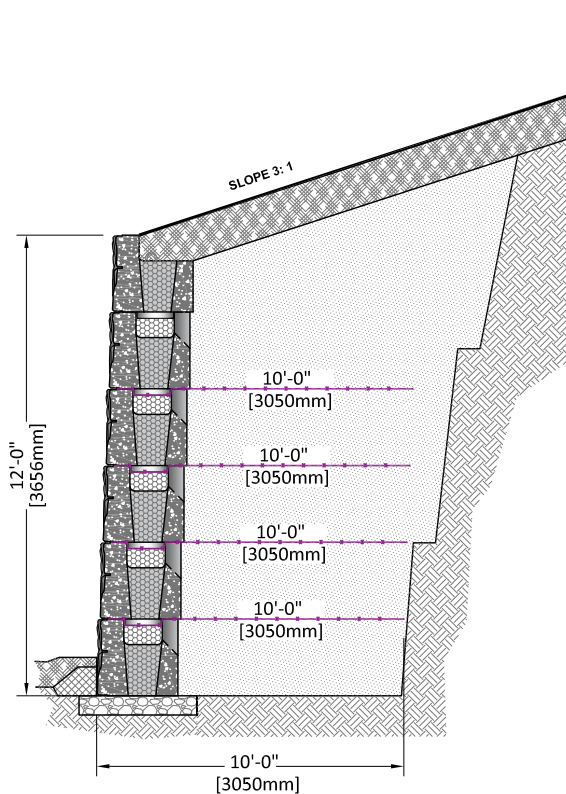
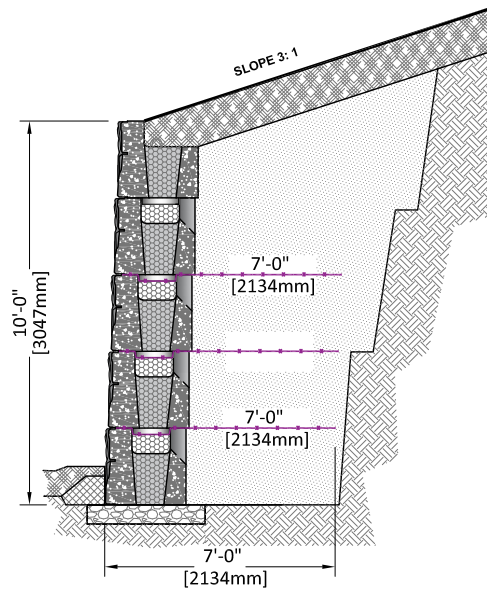
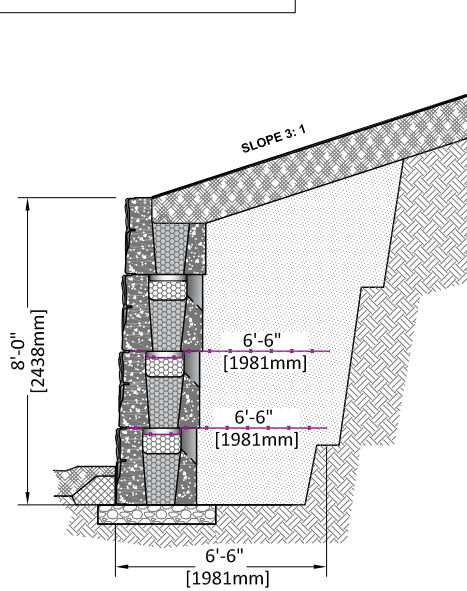
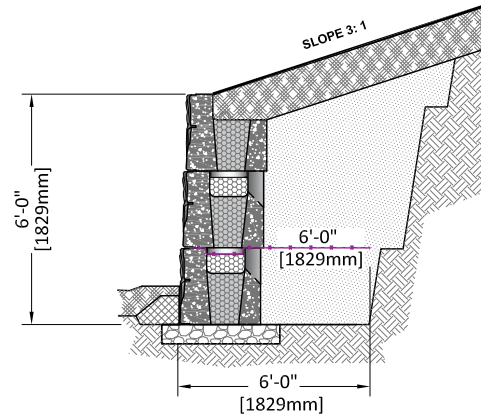

DESCRIPTION

SLOPE ANGLE	18.4° (3H:1V)
LIVE LOAD	0 PSF
RETAINED SOIL	28°
FOUNDATION	28°
REINFORCED SOIL	28°
LEVELING PAD	CRUSHED GRAVEL

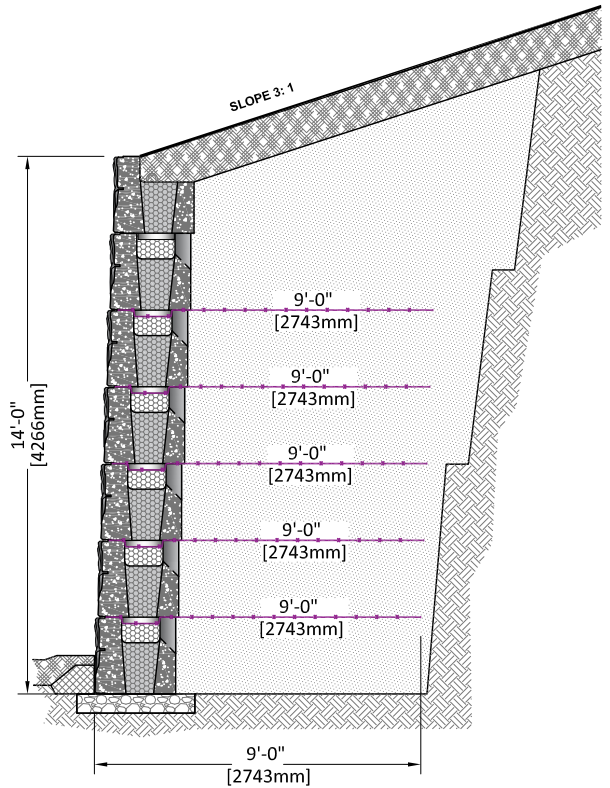
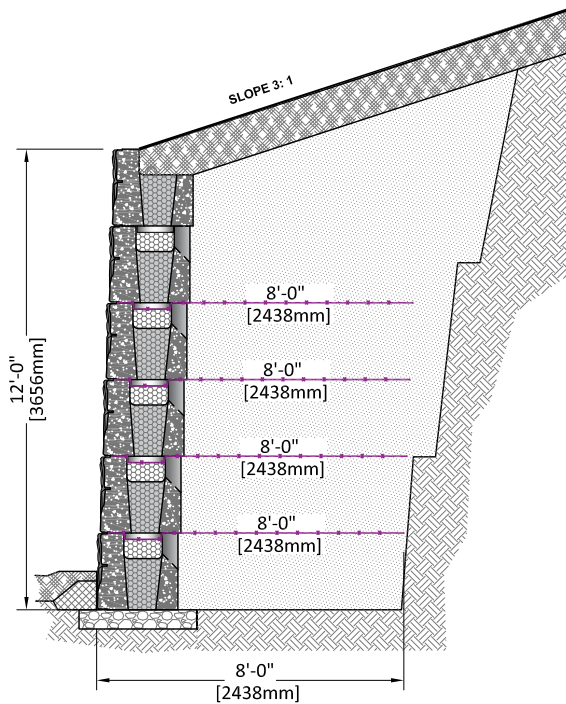
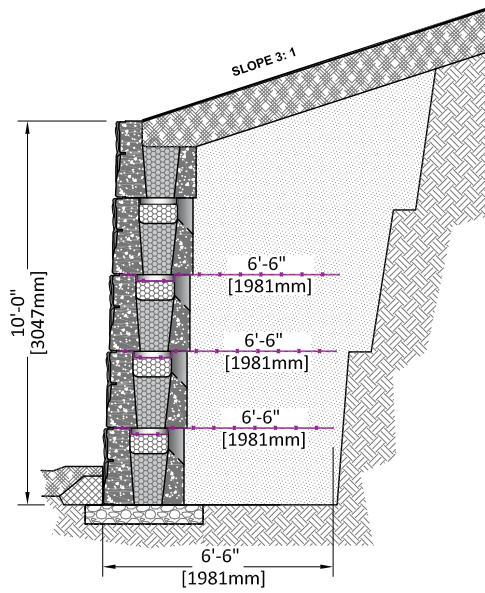
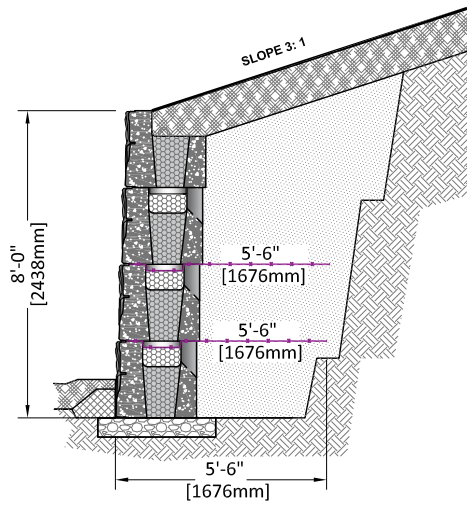
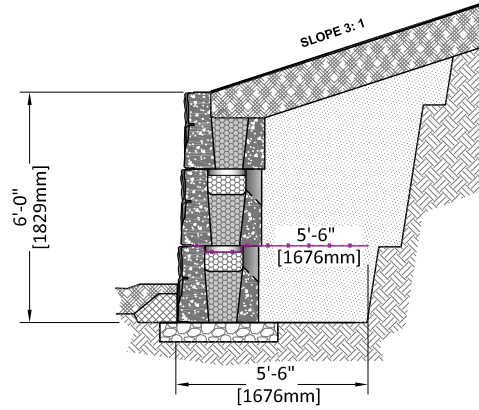

DESCRIPTION

SLOPE ANGLE	18.4° (3H:1V)
LIVE LOAD	0 PSF
RETAINED SOIL	30°
FOUNDATION	30°
REINFORCED SOIL	30°
LEVELING PAD	CRUSHED GRAVEL

GENERAL NOTES:

These drawings are intended solely to act as an aid when designing a wall. This drawing should not be used for final design or construction. Each site-specific wall should be certified and signed by a registered geotechnical engineer in the State or Province that it is being built. The accuracy and use of the details in this document are the sole responsibility of the user.

309

1101-MX-GEO

SHEET REFERENCE

