

MAXUMSTONE INTERLOCK / DRAINAGE DETAIL

SHEET CONTENT

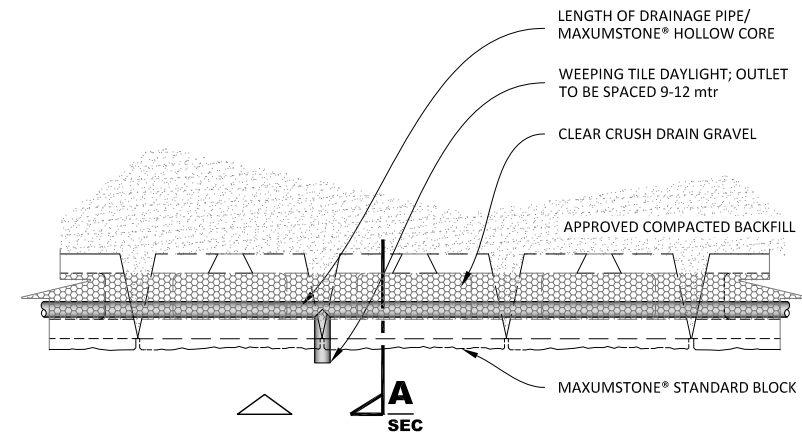

PLAN

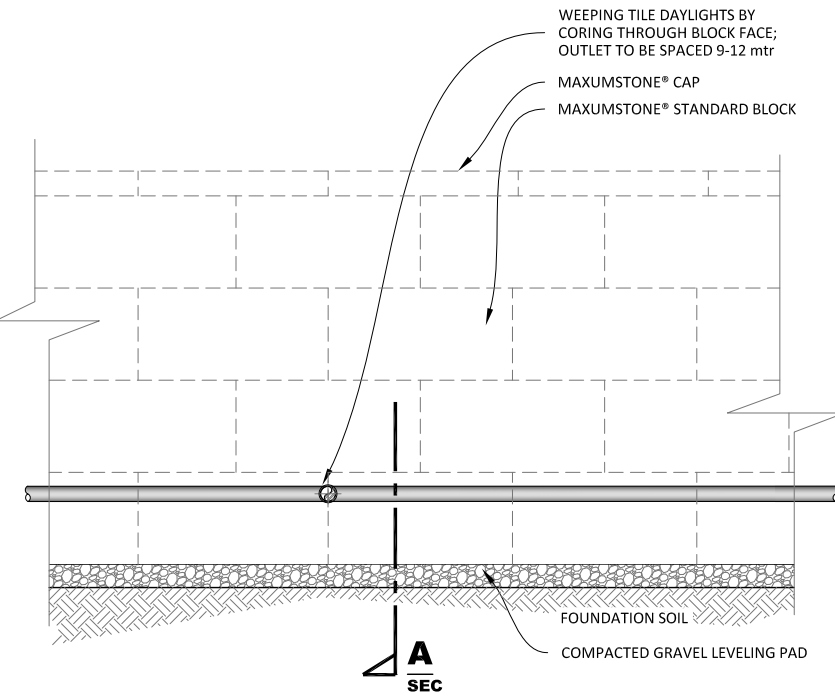

FRONT ELEVATION

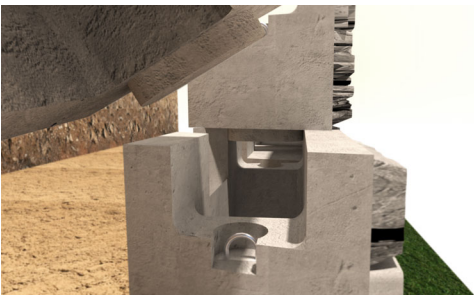

BLOCK INSTALLATION WITH SECURELUG



DRAIN PIPE

PERSPECTIVE

201

0103-MX-APX

SHEET REFERENCE

GENERAL NOTES:

These drawings are intended solely to act as an aid when designing a wall. This drawing should not be used for final design or construction.
Each site-specific wall should be certified and signed by a registered geotechnical engineer in the State or Province that it is being built. The accuracy and use of the details in this document are the sole responsibility of the user.

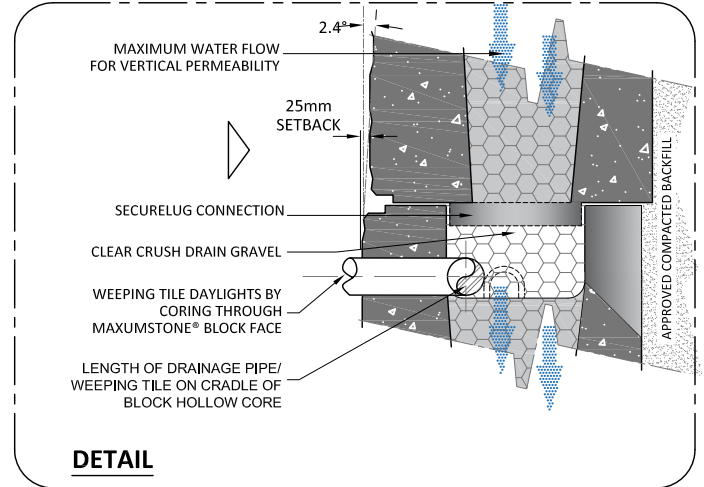

DETAIL

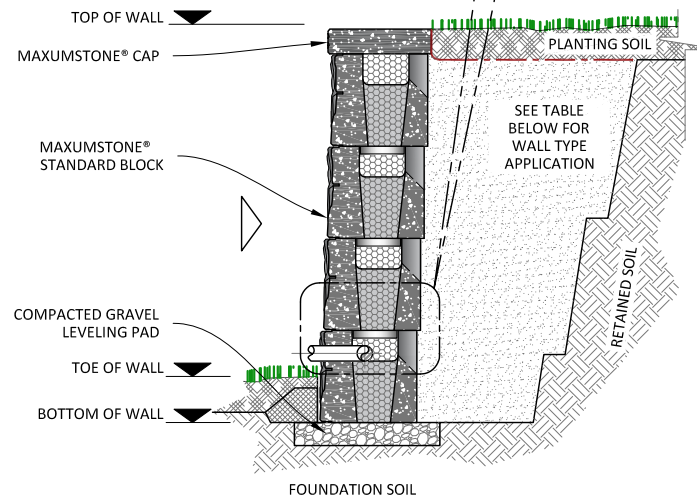

SECTION THROUGH - A

WALL TYPE APPLICATION	
DESCRIPTION	DRAWING REF. NO
GEOGRID RETAINING WALL	1101- MX_GEO
GRAVITY RETAINING WALL	1102- MX_GVT
POSITIVE CONNECTION WALL	1103- MX_PCT
PLANTABLE WALL	1104- MX_PLT
SOIL ANCHOR WALL	1105- MX_ETC
CANTILEVER WALL	1106- MX_CTL
NO FINES CONCRETE WALL	1107- MX_ETC
GRAVITY WALL WITH UTILITIES	1108- MS_ETC
HYBRID WALL	1109- MX_ETC
WATER APPLICATION	1110- MX_WTR
STORMWATER APPLICATION	1111- MX-STM
CONCRETE CULVERT APPLICATION	1112- MX_ETC

GENERAL NOTE:

- FOR MORE DRAIN PIPE LOCATION OPTIONS OF GRAVITY RETAINING WALLS, PLEASE REFER DRAWING 03 / 103_1102 MX_GVT
- DRAIN PIPE LOCATIONS MENTIONED ABOVE ARE POTENTIAL DESIGN SUGGESTIONS. OTHER OPTIONS ARE AVAILABLE AS PER ENGINEER'S DISCRETION
- WEEPING TILE DAYLIGHTS BY CORING THROUGH BLOCK FACE; OUTLET TO BE SPACED 9-12 METERS